

Revision Notes			
R1 - NOTES UPDATED TO INCLUDE LABEL DETAILS, STANDARDS UPDATED AS PER ECR CR- A274.			
AP.A: KILDA	Drawn/BUTLER	Checked/M/BUTLER	Approved/S/LITH
			Date: 28/08/14

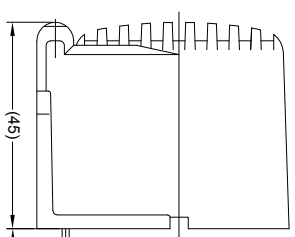

POWER POSITIVE: RED
POWER GROUNDING: BLACK

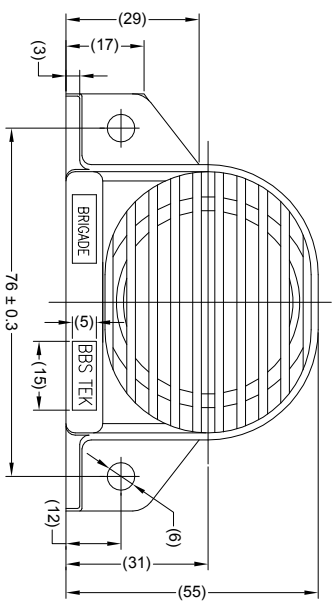
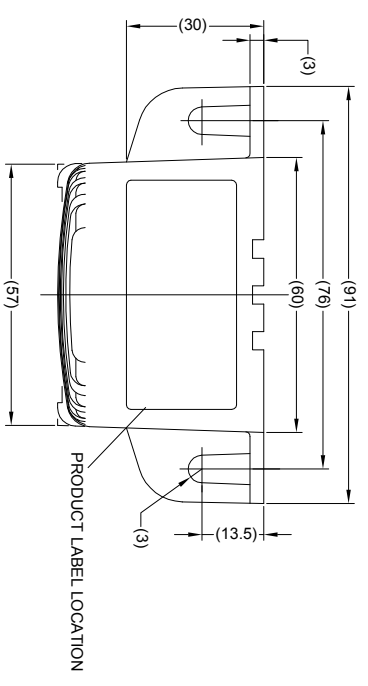
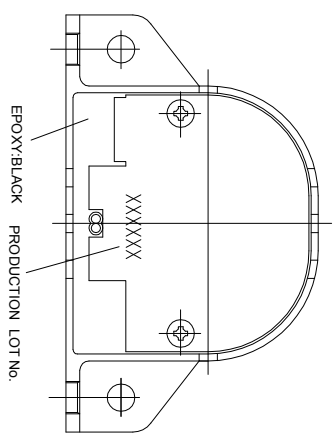

SPECIFICATION:

1. RATED VOLTAGE: 12-24 VOLTS DIRECT CURRENT (WORKING RANGE 10 ~ 32 VOLTS)
2. RATED CURRENT: 0.1 AMPERES OR LESS.
3. SOUND PRESSURE: 62±4 DECIBELS AT TEST VOLTAGES OF 14.28 VOLTS. (AS MEASURED AT A DISTANCE OF 1.2 METERS AND AT A HEIGHT OF 1.2 METERS ABOVE THE GROUND.
4. INTERMITTENCE: 80±10 CYCLES PER MINUTE AT TEST VOLTAGES OF 14.28 VOLTS
5. TONE: WHITE SOUND

- NOTES:
1. FOR PRODUCT LABEL REFER TO LATEST REVISION OF DRAWING: BE-002833-XX-14.
 2. FOR GIFTBOX LABEL REFER TO LATEST REVISION OF DRAWING: BE-002834-XX-14.
 3. 'R' TRIANGLE INDICATES CHANGES MADE TO REVISION OF DRAWING AS IDENTIFIED IN REVISION NOTES.



PROPRIETARY NOTICE

THIS DESIGN AND TECHNICAL INFORMATION APPEARING ON THIS DRAWING IS THE PROPERTY OF BRIGADE ELECTRONICS, AND IS DISCLOSED IN CONFIDENCE. IT IS NOT TO BE COPIED, REPRODUCED, REVEALED TO OR EXPLOITED BY OTHERS, EITHER IN WHOLE OR IN PART WITHOUT THE EXPRESS WRITTEN CONSENT OF BRIGADE ELECTRONICS.

BRIGADE®
www.brigade-electronics.com

Assembly PI Approval	Approved by	Checked by	Drawn by
	DKERAL	DKERAL	DKERAL
Angle of Projection	Units	Scale	Released
	mm	N/A	25/07/06
Third Angle	Status	BBS-62	
	RELEASED	Part No	BE-000389-01-06
	#1578		

